

EN | 19

Kronos | Zefiro
Zefiro Advance
Granduca | Triaca
Livingstone

ROLLER TEAM

**dynamism, style,
personality, technology
e safety.**



ROLLER TEAM

Roller Team is a company gaining an ever greater following, also at an international level, and one of the most significant production models in the European motorcaravan industry.

Established on the foundations of know-how from a historic company on the motorcaravan scene, Roller Team can offer competitive products both in terms of price and equipment, which are at the cutting edge thanks to the excellent construction techniques adopted.

Roller Team, close to the customer everywhere with excellent service.

There are hundreds of qualified outlets that distribute the Roller Team brand today: a comprehensive sales network spread throughout the major European countries. It's thanks to its distribution partners that Roller Team is close to its clientele everywhere, ready to satisfy customers' every requirement with appropriate tools and a wide range of pre-sale and aftersales services. An organised, targeted network, product development in keeping with the habits and needs of different cultures, distribution agencies in the area, staff from the area: these are the secret weapons with which Roller Team presents itself on international markets with growing success.

the choice of value and reliability

One of the main advantages

of choosing a big name is the certainty of the best product **quality** permitted today by technology, materials and a complex industrial process.

That's the reason for choosing **Roller Team**, which works day after day to improve its products and services, making quality its priority so that the price of the product is reflected in its genuine value.

Roller Team:
the certainties.



More insulation, more protection, less noise.
The technology for building living quarters capable of ensuring complete protection for your motorcaravan.
Noise Reduction System is here, the study to reduce noise inside the vehicle when driving.



The motorcaravan that "breathes"
thanks to correct internal air distribution, favouring circulation, making the temperature uniform and preventing condensation from forming.



The Italian with "Nordic" features.
Always at ease in the vehicle, whatever the temperature outside: a motorcaravan designed and built for use in colder climes.



Spaces for your world and your relationships designed for everyday needs and to promote maximum practicality and usability.



Travel All Inclusive.
Solutions for super-equipped motorcaravans with complete equipment for all models.



3590 litres of freedom.
A garage locker designed for you to take your freedom with you anywhere at all times.



In safe hands with motorcaravan "UnderControl".
Roller Team puts its own experience and expertise at the service of every motorcaravan produced. A team dedicated to quality control and continuous improvements follows each motorcaravan throughout the production stage with inspections and tests from design to delivery.

The Roller Team world is just a click away!

Go to **www.rollerteam.it** for comprehensive product details, photographs and retail network.
All news in real time, special activities, special offers and much more.
Connect from your PC, tablet or smartphone and discover the **Roller Team** web world!



more insulation
more protection
less noise



ExPS EVO TECHNOLOGY:
the technology capable of ensuring complete protection for your motorcaravan in terms of:

Greater thermal and acoustic insulation over time
with all wood-free wall structure.

Greater protection from the elements resulting from the use of strong, resistant materials to guarantee a long life.

Greater structural resistance: the materials are not influenced by humidity, heat or impacts, such as hail.

Total insulation in contact zone with the outside **using materials with high insulating performance such as peripheral plastic extrusion or internal extruded PS.**

Maximum shock resistance, easy repairs and easy maintenance.

With Extreme Protection System EVO, 6 years' peace of mind!

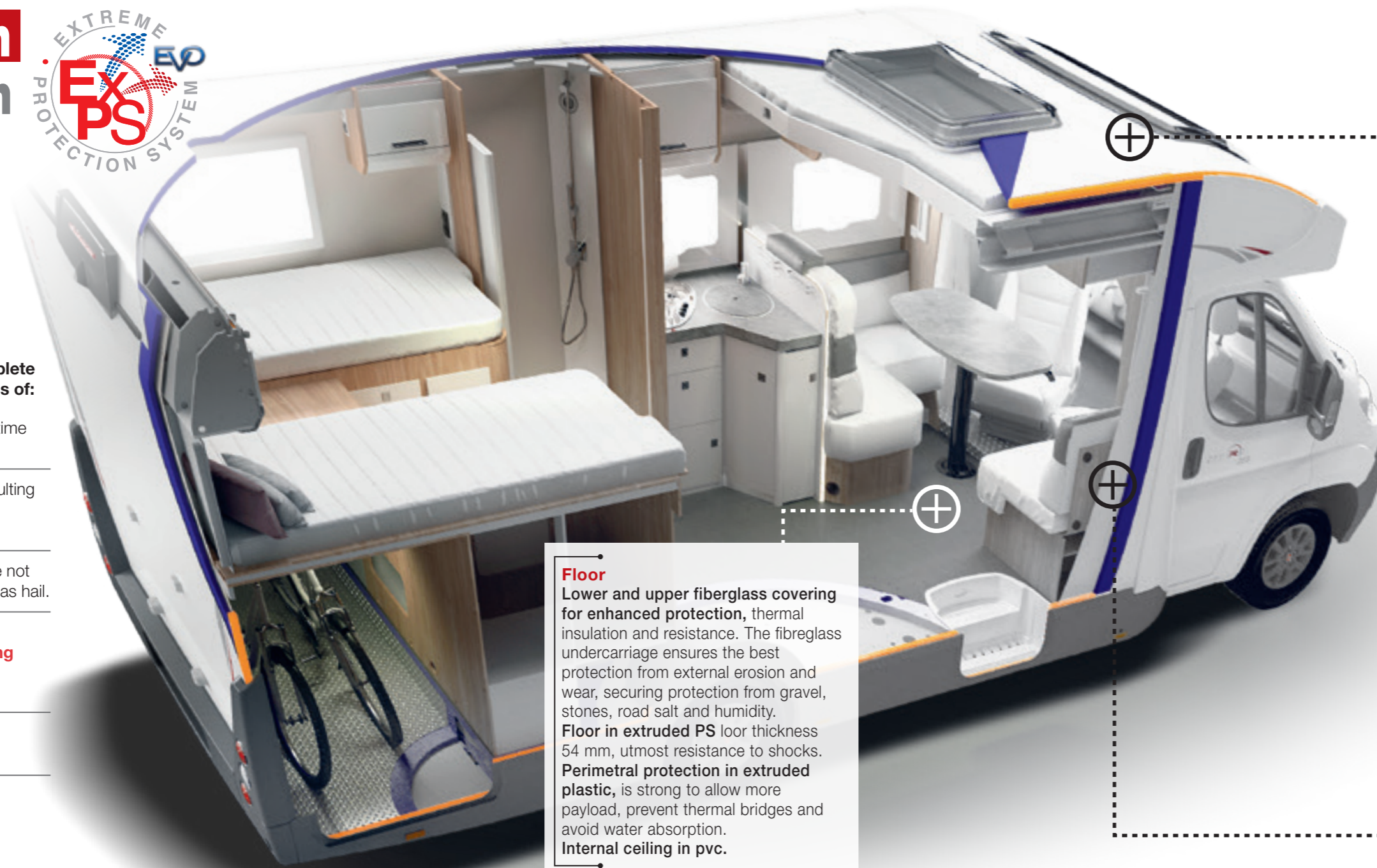

Floor
Lower and upper fiberglass covering for enhanced protection, thermal insulation and resistance. The fiberglass undercarriage ensures the best protection from external erosion and wear, securing protection from gravel, stones, road salt and humidity.
Floor in extruded PS floor thickness 54 mm, utmost resistance to shocks.
Perimetral protection in extruded plastic, is strong to allow more payload, prevent thermal bridges and avoid water absorption.
Internal ceiling in pvc.

Roof
Anti hail roof in fiberglass.
Internal roof in fiberglass.
Extruded plastic inserts in areas in contact with the outside. The use of these materials prevents the formation of heat bridges inside the living pod which may cause condensation or loss of heat.
Roof thickness with extruded PS or a greater insulation and protection. Wood free.

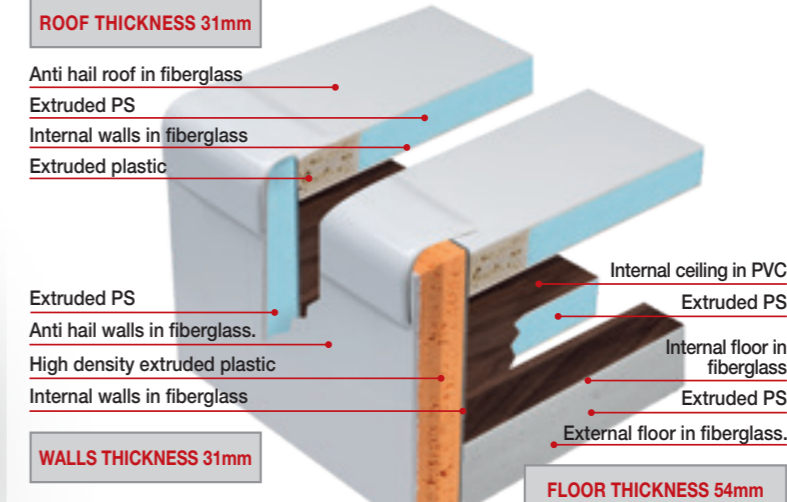

Walls
Anti hail walls in fiberglass.
Extruded PS in all walls: no water is absorbed to limit infiltrations inside the vehicle. Wood free.
High density **extruded plastic**: it prevents any contact of the inner part of the walls with the water.
Internal walls made of humidity-resistant fiberglass without heat bridges which may cause condensation or loss of heat.

Discover ExPS EVO



Noise Reduction Technology

The furniture features protection with soft material for furniture–outer body connection.

A plastic spacer separates the lower floor from the chassis rail.

Roller Team proposes a new assembly system for internal components ensuring greater comfort when travelling thanks to better build quality.

breathe made to breathe

By study of interior climate and air circulation Roller Team offers a motorcaravan that “breathes”.

The **Breathe** project promotes the study of air distribution inside a motorcaravan promoting circulation, rendering the temperature and avoiding the formation of condensation.

Because a motorhome must be well-insulated from the outside but also well-ventilated inside.



Discover Breathe



Permanent ventilation inside wall units.

The units are installed leaving a gap between them and the motorhome wall to promote **uniform air distribution** avoiding the formation of condensation or mould.



A special opening ensures the **free circulation** of air inside the units.



Anti-condensation distanced from the wall itself in the day zone and in the night zone to allow the circulation of air and heat.



Mattresses of the rear beds in **polyester fabric** quilted top and sides. With breathable technical fabric in the bottom part (except overcab and elevating bed models)



Perimeter heating in all models with rear twin beds or rear fixed double bed.

The **slatted frames** of all fixed rear beds and the drop-down bed promotes the flow of air between frame and mattress.

Heating in the overcab.

the italian with a nordic disposition

Designed for distribution From Northern Europe to Southern Italy, every Roller Team vehicle uses technologies and materials that ensure **high performance and a perfect climate.**

So you're always at ease in your vehicle, whatever the temperature outside, Roller Team offers the technology you need... **when you need it!**



Winter holiday included

Enhance your comfort on board still further with original accessories:

- Winter pack: 6000 W combigas or combidiesel heating, with CP Plus, tank insulation and electrical probe, electric heated external pipes, step insulation and insulated cab curtain.
- Heated windscreen. Heated electrically for defrosting. Protects against the sun's rays, lowering the heat transferred inside.
- Electric heated floor (motorhome models)
- Insulated pipe.
- Diesel or gas boosted heater, 6000W.
- Programmable cab heating.

Thumbs up from our northern customers: Roller Team is one of them!

A motorcaravan designed and built for use in the coldest climates: the construction techniques it takes, high-performance materials in terms of insulation and protection from the elements and specific equipment that's also been tested in the climate chamber.

The specifications contained herein may refer to only certain models of the range

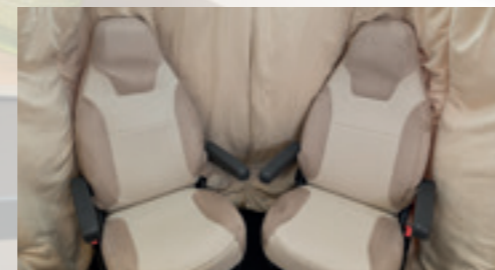

heating



The Alde heating system **features a liquid heat-transfer medium** which is heated by a gas boiler.

According to the same principle that characterises domestic systems, the Alde heating system features a liquid heat-transfer medium which is heated by a gas boiler. A pump circulates the heated liquid in a circuit of interconnected radiators. The radiators heat the air, which is distributed evenly within the motorhome through slits on the wall units. Once the air has cooled, it descends and, passing through slits in the floor, can heat up again and become warm within the circuit.

Let's look at the advantages of heating with a liquid heat-transfer medium.

- ▶ **Healthy atmosphere free from suspended dust** and feeling of dryness.
- ▶ **Even and longer-lasting warmth.**
- ▶ **Low noise** and lack of ventilation.
- ▶ **Continuous production** of hot water.

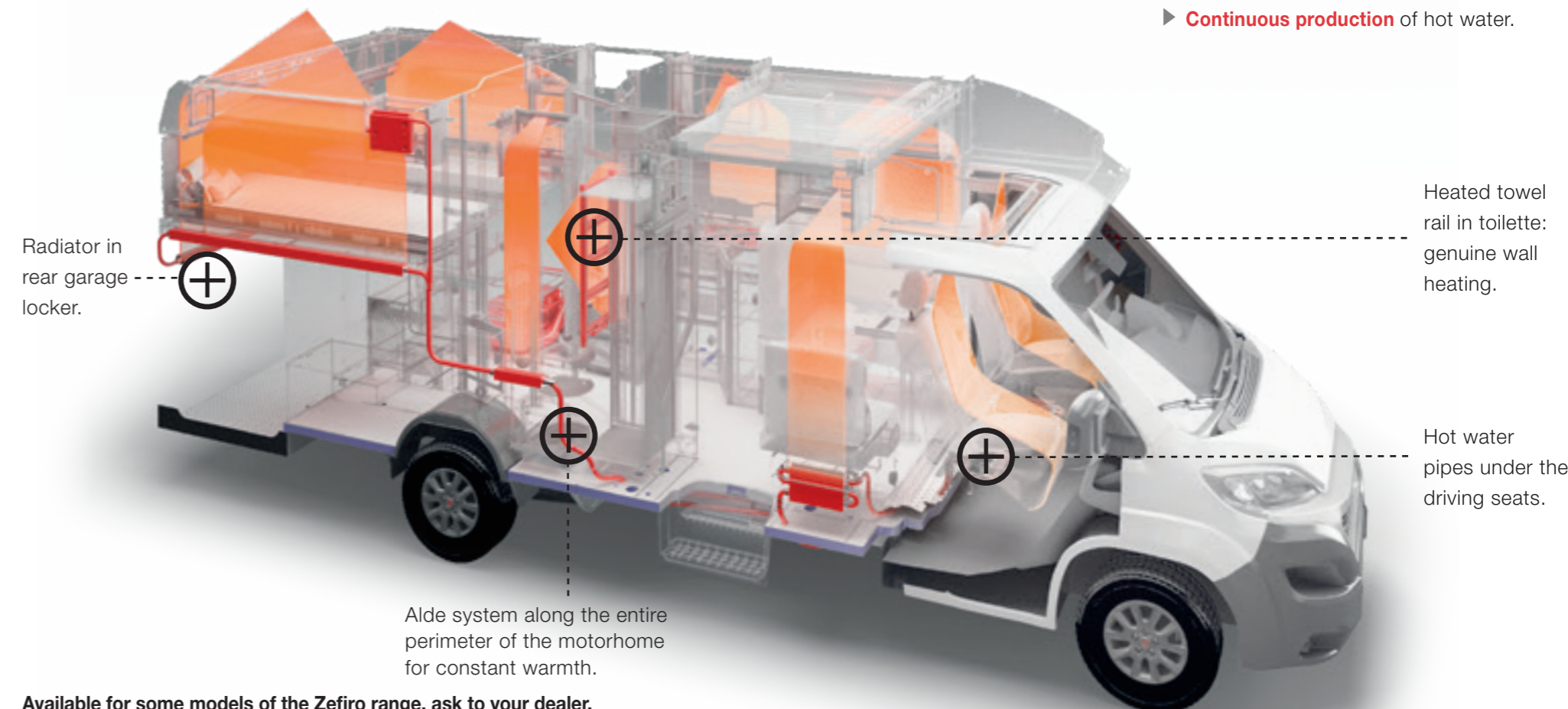

Available for some models of the Zefiro range, ask to your dealer.

3590 litres of freedom!

Because those with big projects need their space.

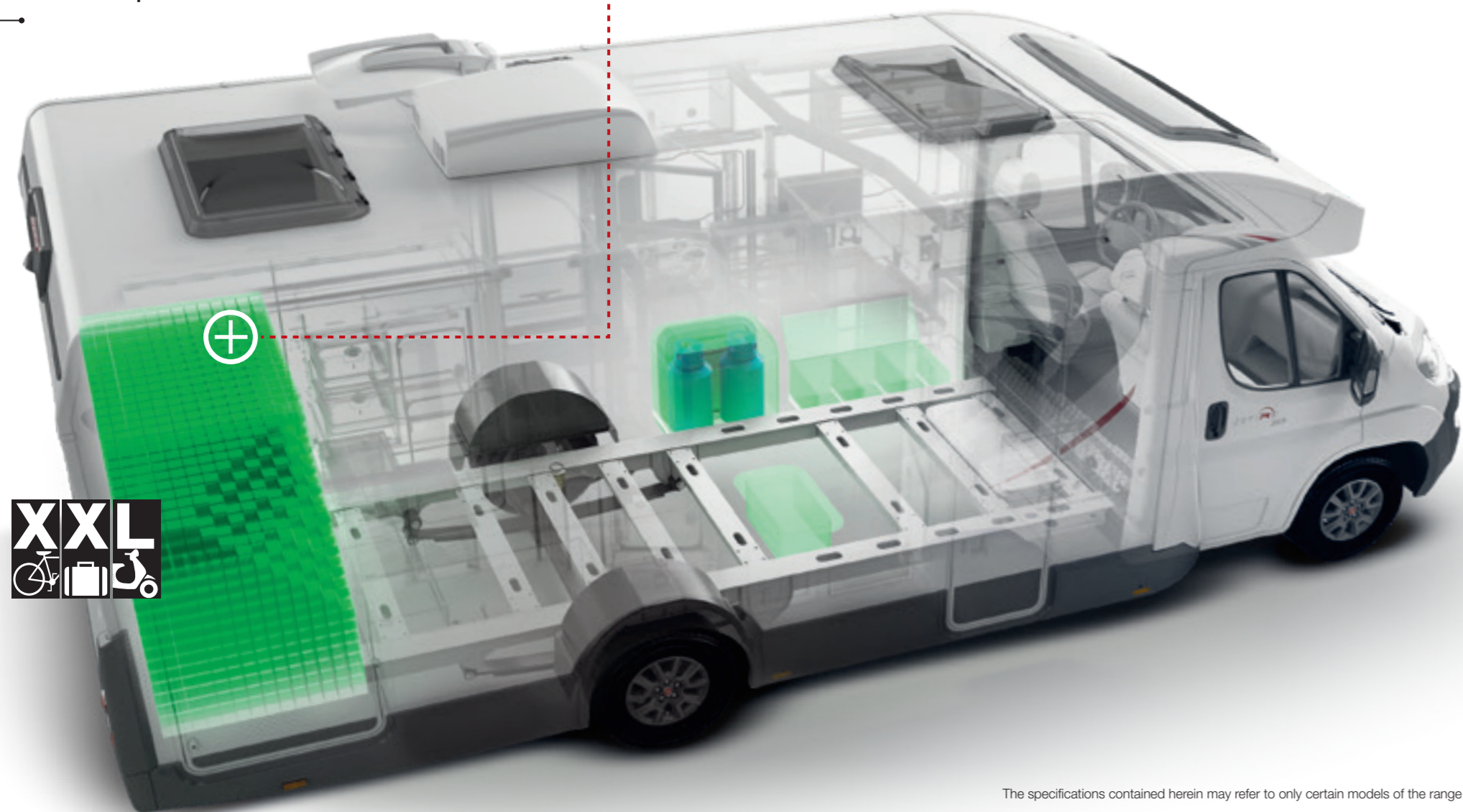

The whole world in the garage!

Withstands up to 300 kg of load (weight that can technically be loaded which affects the number of type-approved places or the remaining total useful load). Can transport up to **3590 litres of material**. Interior height up to **1350 mm** (according to models).

Built properly.

- Lower fibreglass and upper fibreglass and PVC cover for greater heat insulation and mechanical resistance.
- With air vents for heating
- Double lock on each door for extra safety.
- The garage doors are protected from humidity by seals to protect from rain, sprays and freezing to allow safe opening even in cold weather.



Easy to load.



Double door for accessing the locker, passenger side and driver side. Through load compartment which can be accessed from both sides. Doors that open to 180 degrees: extremely simple loading access. Wide passage, among the largest in its category (Kronos range).



So flexible it bends to your requirements.

Where do you want more space? Adjust the volume of the garage to load more ... or have a bigger room!



Flex Space up-and-down bed system for flexible spaces and loads.

You need space, but hidden spaces too!



- Opening stowage locker in side band.
- Storage space in floor.



The specifications contained herein may refer to only certain models of the range

kronos 290 M

born for sports

As big as your enthusiasm!

An exclusive ROLLER TEAM. Whatever your favourite sport, live it to the fullest with Roller Team Kronos 290 M, a new and exclusive product designed so you can enjoy your great interests in style and comfort! Maxi garage for motorbikes, bicycles, quad, kart, mobile workshop, tool shed or even to set up shop. Everything without requiring you to give up any of the essentials you need for leisure: Kronos 290 M is multifunctional because the particular design of the rear zone does not skimp on living space.



▲
Maxi side door
dimensions
1370 x 1320 mm.

▲
Load volumes 1930 x 2200 x 1430 (h)
mm. With Flex Space height
up to 1820 mm.

▲
**300
Kg**
Maximum payload.



▼
Floor with removable rubber protection.



▼
Water drain grids on floor.



Enjoy the motorhome made to
measure for your needs.

The only one equipped so you
can live **your dream of
being born for sports!**



Provision of wall with aluminium bars
for attaching custom equipment.

Internal LED lighting.

Internal space and
surfaces for equipment
(compressors, tool drawers, etc.).

Two wardrobes for storing sports
gear, one of which removable.



▼
Washable surface with extractable
shower head.



▼
With TV and 12V – 220V electrical
socket.

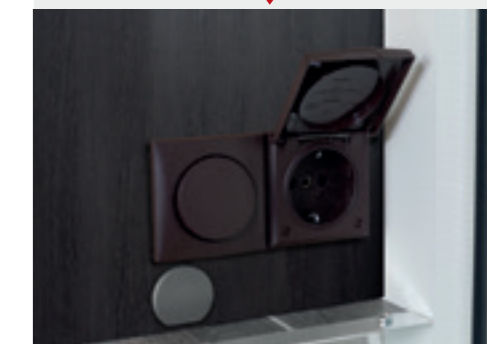

spaces to experience to the full...

I FEEL GOOD

Spaces for your world and your relationships.

Spaces designed by expert hands in a continuous exchange of usability, necessity and practicality. Roller Team, a well-made motorcaravan able to guarantee:

- ▶ **paces to experience to the full**
- ▶ **Room for everything**
- ▶ High-performance materials suited to everyday use

The specifications contained herein may refer to only certain models of the range

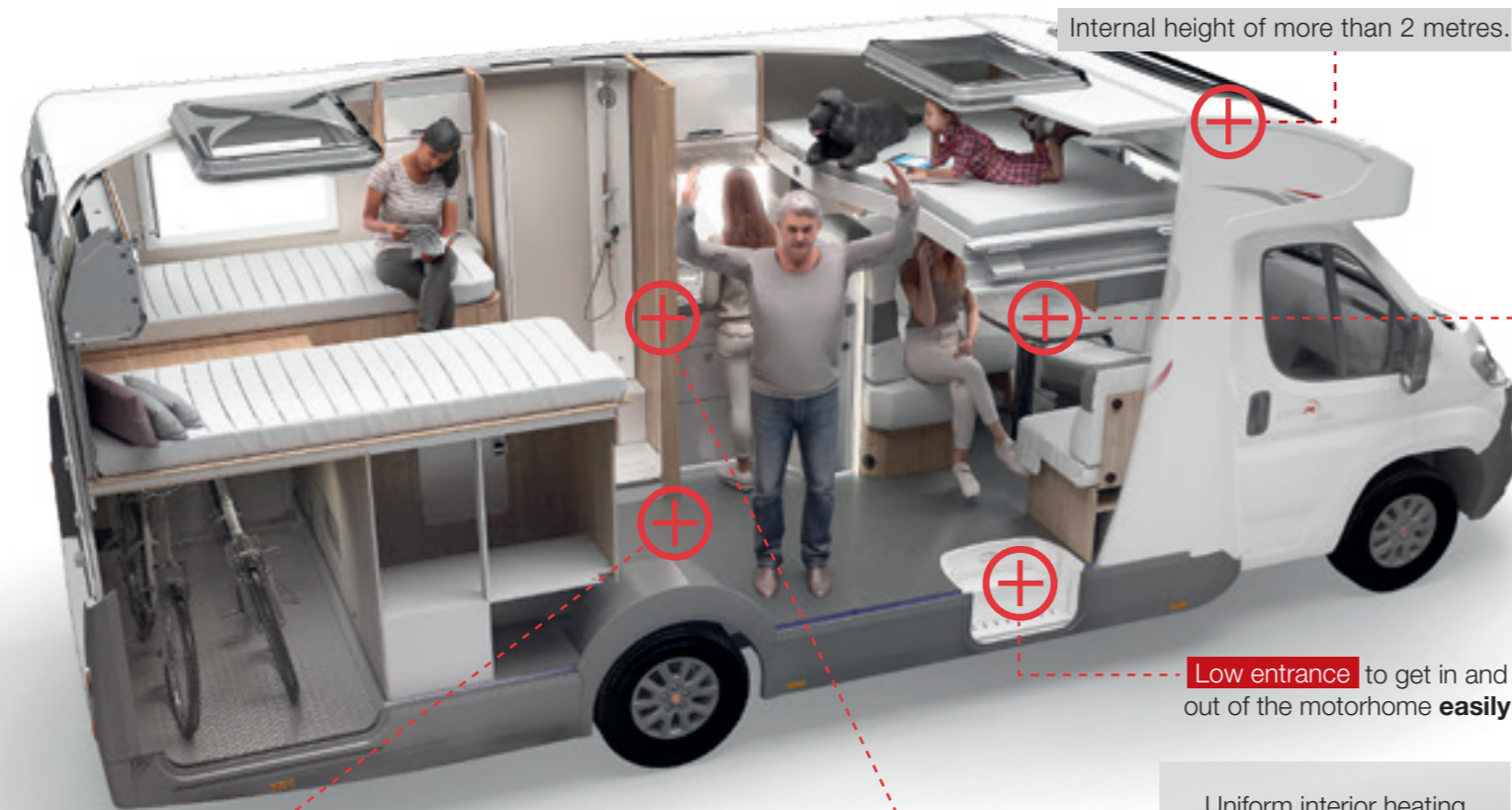

Internal height of more than 2 metres.

Low entrance to get in and out of the motorhome **easily**

Uniform interior heating through hot air vents with particular focus on the critical, exposed areas of the living pod, like the driving cab, the rear garage, the night zone and the overcab area.

Floor on a single level, without steps.



USB ports in the day zone to recharge smartphones and tablets, right **where you need them** the most.



Sliding doors for your privacy, separating the living area from the sleeping area.

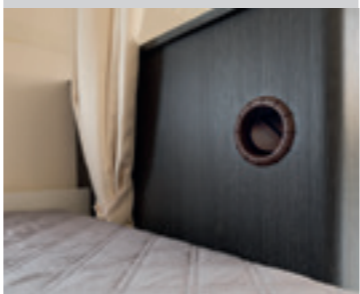

Folding table for an adaptable space: the perfect solutions to join the need to contain dimensions to clear room for your everyday activities. 360° adjustable one-leg island table for more freedom of movement.



LED lighting : better lighting performance and energy saving – **more energy-efficiency, more autonomy, longer battery life.** Pleasant and uniform indirect lighting through light strips and frames; LED spot lights for reading without annoying your travel mates and for more direct light; courtesy lights on the floor to find your way at night.

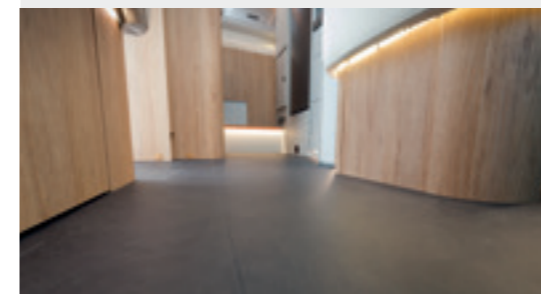

... and safety

- ▶ **Exterior light** on the entrance door for extra safety. No need to fumble for keys in the dark*.
- ▶ **Centralised locking system with remote control**** for living pod and driving cab doors.
- ▶ **Standard reversing camera** ***: safer manoeuvres by providing a view of the areas behind the vehicle.

Standard set-up allow dealers to install aftermarket accessories easily and safely without compromising the structure of the motorhome or its systems.

* Except for Kronos range
** Standard on Granduca and Triaca, optional on other ranges
*** Zefiro, Granduca and Triaca

spaces for your world and your relationships

Flexible, practical use,
like the kitchen at home.

Like all other environments,
the kitchen of a motorhome
must comply with specific needs
firstly that of allowing freedom
of movement and the practicality
of perfectly managed spaces.

Roller Team kitchens in addition
to being welcoming combine
ergonomic and practicality by
implementing solutions which:

- ▶ **minimise movements inside;**
- ▶ **facilitate everyday cooking;**
washing and cleaning
activities;
- ▶ **optimise the available space,**
integral generous storage
areas.



"Social Kitchen": 2350 mm of
exterior length for **more living**
space inside! A wide passage
that allows cooking, passing,
stopping ... all together!
(except Granduca range).
A space where the pleasure of
cooking is naturally associated with
the pleasure of relationship.

The kitchen is the environment of the
motorhome that is most stressed by
use, heat and time. For this reasons,
high-performance materials are needed with
strong, large working surfaces,
high-quality appliances, durable furniture
and units, generous storage.

Acrylic stone tops: Resistant to scratches
and knocks, Long-lasting with scrubbing,
Easy to clean, Antibacterial.



Home-inspired equipment.
Three-hob cooktop with adjustable
electric lighting. Glass cover to **extend**
the work top surface when the cooktop is
not in use. Extraction hood, on the Granduca
range. Possibility of optional oven.



Refrigerators up to 150 l with freezer, or 140 l slim
fridge for for more living spaxe inside with froster and
bottle compartment, **with automatic energy-saving**
switch 220 V, 12 v or gas (according to the models).

in the kitchen

everything to hand and space for everything

Deep drawers and bins with **soft-close and automatic locking function:** more room, better access and improved tidiness with respect to furniture within swing doors.



Pull-out sliding baskets with chrome metal edges.

Lower gas cylinder compartment to avoid using up valuable kitchen space. The lower position also makes replacing gas cylinders easier.



High units for more storage.



Completely pull-out tall storage units or bottles and small containers, with lock.

Kitchen and dinette side partition with containers.



L-shaped kitchen

More freedom of movement and action in a more compact space: washing up, cooking and preparing food is easy.

A pleasant zone with cooktop, refrigerator, work tops and storage all within arm's reach

The large work top can be extended with a sink cover and glass cooktop cover. Enough room for remarkably capacious refrigerators.

Storage in large extractable bins and deep drawers, often combined with storage columns that can be pulled out entirely.

Longitudinal kitchen

Available in two versions – maxi or compact:

all functions along a single wall.

Extendible work top in a few simple steps courtesy of folding additional surfaces.

Plenty of **freedom of movement in the corridor, brighter and better ventilation** because the window is particularly large.

The specifications contained herein may refer to only certain models of the range



The large and deep sink, very handy for washing up even the largest dishes.

Very generous drawers with **plenty of room** for tools and food.

in the bed sleep well sleep long

Here are our
rules for getting
up on the right
side of bed.

Bottom of mattresses -
made of technical, quilted
breathable fabric. Top and sides
made of quilted polyester.

Slatted bases for all
fixed rear beds.



LED night-time courtesy lights in the floor. LED spot lights
under the units for more direct light for reading books without
annoying your travel mates.

The specifications contained herein may refer to only certain models of the range

Side windows
for excellent ventilation
in the night zone.
Skylight over the bed
for more air and to
stargaze.

Central bed

A real bedroom with nautical-style
double bed, **truly excellent dimensions**
up to 150 cm wide and 190 cm long,
with **adjustable backrest** on some
models. Complete with two bedside
tables on the right and left sides for
books, drinks and accessories, with two
wardrobes on top.

Easy access from both sides using
steps which double as storage
compartments with easy access to the
foot of the bed, **the bed frame can**

be lifted to access the storage space
under the bed.

Maximum privacy guaranteed by
sliding doors which separate the day
area from the night area, paired with
toilette and shown cubicles, usually
separate in two different environments.

**More flexible access to bed or
garage loading areas with Flex
Space** the up-and-down bed system.



Central bed with crosswise toilette cubicle

Variable space in the night zone, **easy to
access** bed, provided with shelves and
wardrobe on both sides.

**The toilette is positioned crosswise at
the foot** of the bed and is separated from the
bedroom by two sliding doors, one between the
bedroom and one between bedroom and shower
area. **Locker room area and plenty of room
for moving about.**





Twin beds

Two **generously sized**, single bed arranged longitudinally, **easy access to beds** with large steps which can also be used for storage, provided with work top in the middle and units. Wardrobes under the bed with access from front doors or from the top using a pull-out frame lifting system. Additional cushions with standard



wooden extensions to **turn the single beds into a crosswise comfortable double bed**.

Peripheral heating using specific vents on the side walls of the beds. **Optional on models 284, Flex Space, up-and-down bed system for flexible spaces and loads.**

Rear bed with garage

Excellent use of space with the bed perfectly integrated in the entire width of the vehicle over the garage. Wardrobe positioned by the side of the bed. Storage is maximised by generous units on the wall over of the three sides of the bed. Access to the bed is guaranteed by an integrated or

extractable ladder at the feet of the bed. **Peripheral heating** using specific vents on the side walls of the beds.

More flexible access to bed or garage loading areas with Flex Space the up-and-down bed system.



Bed transformable into dinette

For the most eagerly awaited or unexpected guest! The dinette turns into an extra bed. **Easy to transform**: simple move the table down and insert the cushion. The extra bed is ready.



Electric folding bed

Plenty of living space and minimum dimensions during the day, when it is closed against the roof, **comfortable and practical** simply by lowering the bed using the electrical system, **at night**, single or double according to the model, in some cases even **maxi - 136 cm wide**, can be stopped at any height, **the dinette and the kitchen can be used** even when the bed is down.



Overcab

A double bed always ready, plenty of room for sleeping, plenty of room for storage large objects during the day, plenty of usable room with **being 700 mm high in the middle** **can be lifted** to gain easy access into the cab. Ventilation, light and heating are guaranteed by appropriately arranged windows and vents.

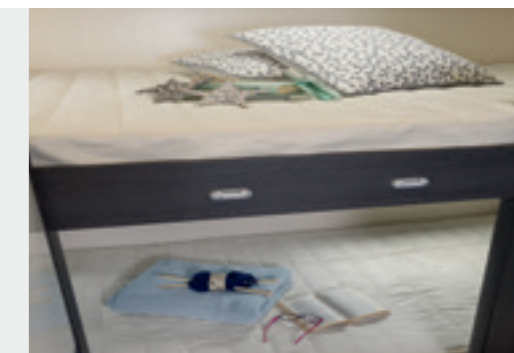

Crosswise bunk beds

Excellent sized beds, **great flexibility** with the lower bed which can be lifted to extend and access the garage. Exclusive Roller Team models, **Exclusive Roller Team models, Zefiro 274 TL, seven passengers and seven berths**, a maxi dinette with face-to-face arrangement. **Kronos 279 M** with **double bunk beds for four berths** and a second double bed which can be lifted to choose from four fixed rear double beds or storage space when the bed is not in use.

a corner dedicated to yourself

The toilette is a pleasant
place designed for your wellbeing
and not just a simple facility,
Roller Team puts the focus on
functionality and ergonomics.



All-wood furniture.

Generous furniture with mirror so you
need to give nothing up.
Light integrated in the mirror.

230 V socket for hair-dryer or electric
shaver.

Towel rack.

Wash basin with mixer tap to adjust
water temperature a flow.

Ventilation and light are guaranteed by
mirrors and even a fan in the roof.

A bar in the shower cubicle on some
models is perfect for drying sports gear
and hanging long garments.

Sufficiently roomy shower, height up to
195 cm (Kronos 265 TL), with storage
shelves, mixer tap and removal shower
head.

Double drain in floor the water flows
out faster even when the motorhome
is not parked perfectly flat.

Central linear toilette

available on models with crosswise bed, bunk beds,
over or under 7 metres. This type of toilet provides
the most freedom of movement and high comfort.
The shower is separated from the toilette by a
rigid door with storage shelves. The toilet furniture
is made of wood and has generous storage room
for accessories. This solution generally offers large
mirrors and good lighting and ventilation.



Compact linear toilette

The perfect trade-off offering a high level of comfort
on more compact models in which the living area
is maximised. A world-class outfit in terms of room
and functionality: the shower is separated by a folding
rigid door and the units are adequately capacious.

Independent toilet and shower

Versatility is the keyword of this living solution because
the space can be optimised to guarantee remarkable
freedom of movement inside the motorhome.
The advantages: separate and simultaneous use of
the two environments, more passage space towards
the night zone which can be used as locker room,
maximum privacy guaranteed by the separation door.



performance and safety start here

All Roller Team models are built on chassis specifically designed to be converted into motorhomes taking into account **mechanical performance and above all safety, comfort when travelling and when parked over time.**



The **Ford Transit Chassis** is equipped with a new Ford EcoBlue 2.0 TDCi engine, delivering from 130 to 170 hp of power for better performance and lower CO² emissions. It is **Euro 6** compliant.



16" wheels
Cruise Control

ASR anti-slip system to limit loss of wheel grip.

ESP electronic stability program for correct vehicle trim.

ABS to prevent even minimal loss of control.

Standard driver and passenger **airbags**

ESC electronic stability control system monitors vehicle handling to help the driver stay in control.



Adjustable **cab seats** which can revolve by 180°, with integrated armrest and head restraint, to find the best position.

Radio with controls on steering wheel. Plenty of room for bottles, telephones, maps and guides in the cab.

Optional equipment:

SelectShift six-speed automatic transmission for a relaxing driving experience. Not available for 4100 kg chassis with 1000 kg limit on tow hook. Possibility with 4100 kg chassis.



Only Roller Team offers five years of Ford Protect, the extended warranty programme that adds three years to the basic two taking the total chassis warranty to five years or 80,000 km. Applicable for all Roller Team models with 2.0 L Ecoblue engine, compliant with Euro 6, registered after July 1, 2017.

Specifications

- Specific motorhome chassis with lower centre of gravity for easier access to the living pod.
- Steel ladder frame chassis, flat and strong, allowing for a perfect living pod layout.
- Wider rear tread for better stability on the road and more living comfort inside.

Equipped with a wide range of technologies designed **for safe driving in all situations:**

Engineers on the basis of continual partnerships with manufacturers, Fiat Ducato is the perfect union of chassis and living pod. Plenty of features are provided to facilitate conversion, in addition to specific electrical system and cab designed with reinforced pillars and precut roof.



Tyres suitable for long stops and with low rolling resistance to reduce consumption.

Chassis lowered by 15 cm.
Lower height and more stability.

Radio aerial integrated in the rear-view mirrors.

Headlights are positioned higher up:
better light beam width on the road and reduced possibility of damage.

Many variants of **Turbo Diesel Euro 6 engines**, securing high torque at high rpm for speedy acceleration, fuel efficiency running and low CO² emissions. Chassis range: 3650 kg or 4250 kg or 4400 kg.

The steering wheel has a typical automotive slant. It can be adjusted axially with a stroke of 50 mm.

The dashboard features bottle holders and storage compartments, both open and closed, integrated cup holder and container for smartphones or mp3 players.



The best cab equipment:

- Manual climate control system
- Cruise Control with Speed Limiter.
- **ASB** the wheels do not lock in case of sharp braking and help maintaining directionality.
- **ASR** prevents slipping of the wheels during acceleration.
- **ESC** monitors acceleration, speed and grip.

Chassis Special

- Specific for motorhomes, with high torsion strength, lower to facilitate getting in and out, light and functional. With independent wheels and anti-roll bar as standard on the front and rear axles. Chassis lowered by 15 cm. Lower height and more stability.
- Wider rear track: 1980 mm, more stability and more room for the living pod.
- Captain chairs with integrated head restraint, wide backrest, improved side containment, double armrest. On pivoting plate, in addition to being adjustable in height and inclination, they can turn by 180° and once turned they can slide forwards to move closer to the dinette.

The options include:

- Traction +: vehicle stability control device, the Hill Holder assistance system for climbs, or Hill Descent system for coming down, and the traction support device for poor grip on a single drive wheel.
- Automatic transmission: increases your driving comfort and reduces fuel consumption by up to 5%.
- TPMS: tyre pressure control system for more safety, better fuel efficiency and lower emissions.

Because we know that satisfying our customers depends greatly on the quality of our products.

Roller Team puts its **own experience** and expertise at the service of every motorcaravan produced and follows it throughout the production stage **with inspections and tests** from design to delivery that meet with European standards.

The same quality standards are demanded of suppliers: for the **most strategic** components, a check is carried out when the material is received and before it is used in production.



Checks in production stage

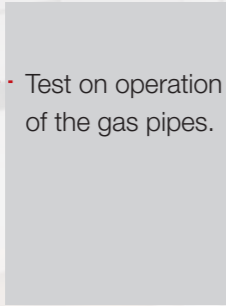

Test on operation of the gas pipes.



Check on operation and correct installation of the electrical systems.



Correct installation of the hydraulic systems.

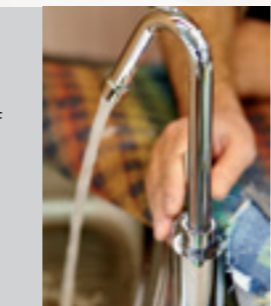

Tests in research and development and prototyping stage

Specific testing in climate chamber to check the resistance, duration and performance of the materials selected at extremely high/low temperatures.



Performance tests on the components used: durability of mattresses, resistance to stress, reliability and compliance with European regulations in the design of the seatbelt unit.



Gas system inspection by certified staff according to the German DVGW protocol.



check 100
100 statistical checks on a percentage of the vehicles produced: aesthetic, functional, noise and fitting tests.

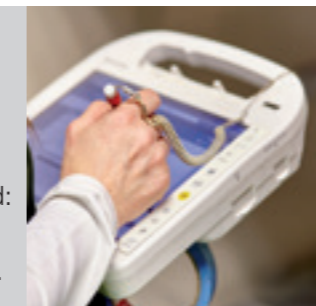

Test on finished product.



Waterproofing tests on 100% of the vehicles produced, before delivery.



Electronic weighing of 100% of vehicles before delivery and written weight certification for end customer.



kronos

never stop dreaming... now you can!

IF YOU DELIGHT IN OUTDOOR HOLIDAYING BUT HAVEN'T
YET BEEN ABLE TO OWN A MOTORHOME OF YOUR OWN,
HERE'S THE SOLUTION FOR YOU.



Discover Kronos

Photo @Alessandro Bacci

low-profile

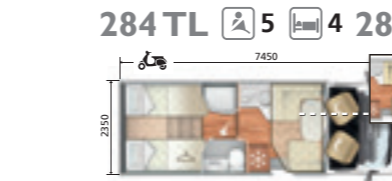
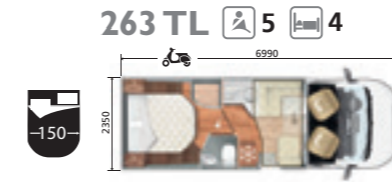
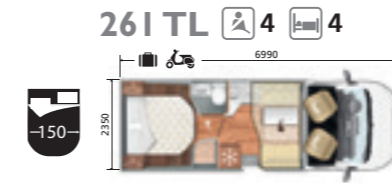

- ▶ One of the most extensive range on the market
- ▶ Choose the mechanics you prefer: all overcab and drop-down motorhome models are available on **Fiat or Ford** chassis.



- ▶ The best **price-to-equipment** ratio on the market: Kronos, affordable, fully equipped, all-inclusive.
- ▶ Large choice of living dinette or **face-to-face** arrangements.

overcab

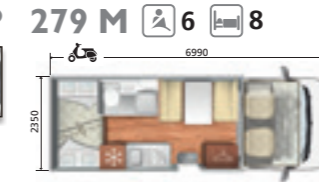
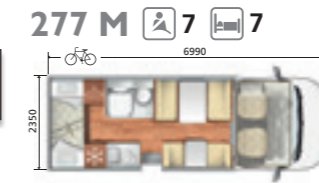

- ▶ Social Kitchen: 2350 mm of exterior length for more **living space inside!**
- ▶ In the kitchen, **everything is handy and tidy** with deep drawers and automatic soft-closing bins. High overhead lockers.

motorhome



Choose among 19 models
three versions
drop-down,
overcab and
motorhome.



ALL-INCLUSIVE

- ▶ Manual climate control system
- ▶ Driver and passenger airbags
- ▶ Cruise Control
- ▶ ESP (Ford)
- ▶ Integrated antenna
- ▶ Bluetooth radio with controls on steering wheel (Ford)
- ▶ Radio setup (Fiat)
- ▶ Painted bumper (Fiat)
- ▶ Door with fixed window
- ▶ Entrance door flyscreen
- ▶ Swivelling seats with seat covers (where available)
- ▶ Type-approved fifth seat (where available)
- ▶ Bed slats
- ▶ Open sky, panoramic roof (low-profile models)
- ▶ 6-year infiltration warranty
- ▶ 5-year mechanical warranty (Ford)

More lengths
from 6470 to 7450 mm



Kronos 284 TL



Kronos 279 M, 295 M



Kronos 263 TL, 265 TL, 284 TL, 284 M, 286 TL, 294 TL, 295 TL



Kronos 290 M



Kronos 265 TL, 284 TL, 284 M, 286 TL



Kronos 279 M, 295 M



Kronos 267 TL, 287 TL



Kronos 267 TL, 287 TL



Kronos 267 TL



Kronos 265 TL, 284 TL



Kronos 284 TL



Kronos 265 TL



Kronos 279 M



Kronos 284 M, 290 M

zefiro

**the strength of quality
and value over time.**

AN EXTRAORDINARY MOTORHOME FROM ALL PERSPECTIVES,
WHICH THANKS TO CONTINUOUS RESEARCH AND
OPTIMISATION HAS SUCCESSFULLY IMPROVED IN TERMS OF
QUALITY, RELIABILITY, STRENGTH AND VALUE OVER TIME.



Discover Zefiro



low-profile

235 TL 4 4



263 TL 5 4

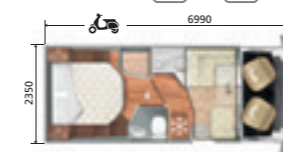

265 TL 5 4 265 P



266 TL 5 4 266 P



274 TL 7 7



282 TL 5 4 282 P



283 TL 5 4 283 P



284 TL 5 4 284 P



285 TL 5 5 285 P



294 TL 5 4



295 TL 5 4 295 P



298 TL 5 4



overcab

277 M 7 7



284 M 5 4



285 M 5 4

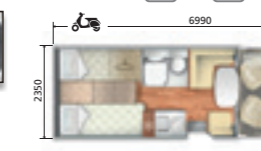

295 M 6 6



motorhome

265 integral 5 4



266 integral 5 4



282 integral 5 4

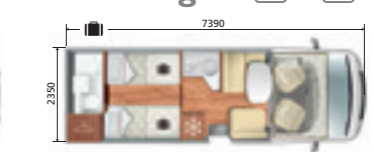

285 integral 5 4

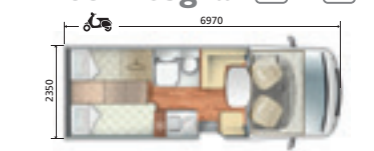

295 integral 5 4

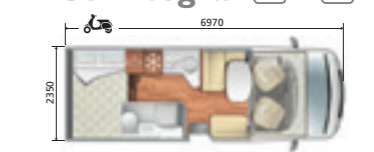

284 integral 5 4



22 models to choose from

three types

overcab,
low-profile and
motorhome,



Zefiro

ALL-INCLUSIVE



- ▶ Manual climate control system
- ▶ Driver and passenger airbags
- ▶ Cruise Control
- ▶ Built-in antenna and radio setup
- ▶ Painted bumper
- ▶ Door with fixed window
- ▶ Entrance door flyscreen
- ▶ Revolving seats with seat covers (where available)
- ▶ Type-approved fifth seat (where available)
- ▶ Bed slats
- ▶ Open sky, panoramic roof (low-profile models)
- ▶ Rear-view camera
- ▶ Solar panel
- ▶ 6-year warranty

▶ In the kitchen, **everything is tidy** with deep drawers, automatic soft-closing bins and overhead lockers for plenty of storage.

Pull-out sliding rawers with chrome metal edge. **Tall, pull-out storage units** per for bottles and small containers.

▶ Social Kitchen **Plenty of interior space** with exterior length of 2350 mm.

Various lengths from 5990 to 7430 mm.



Zefiro 295 Integral



Zefiro 298 TL



Zefiro Integral



Zefiro 298 TL



Zefiro 265 TL, 266 TL, 284 TL, 294 TL, 295 TL



Zefiro 298 TL



Zefiro 295 M, 295 TL, 295 Integral, 298 TL



Zefiro Integral



Zefiro 284 e 285 M, 284 e 285 TL , 284 e 285 Integral



Zefiro 265 TL, 265 Integral



Zefiro 298 TL

zefiro advance

the pinnacle of excellence with
even more equipment and design!



Discover Zefiro Advance

low-profile

265 TL 5 4

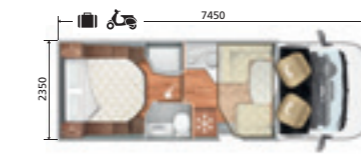

294 TL 5 4

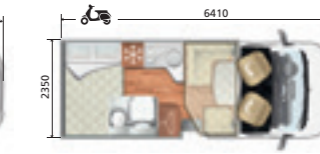

284 TL 5 4



295 TL 5 4

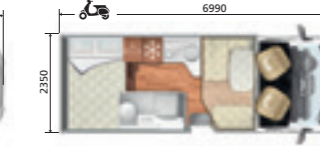

Zefiro Advance

ALL-INCLUSIVE



- ▶ 16" alloy rims and composite suspensions
- ▶ Pleated cab blinds
- ▶ Door with two centralised locking points
- ▶ CP Plus
- ▶ Bluetooth Radio with Navigator and controls on steering wheel
- ▶ Insulated tank and electrical probe
- ▶ Electrically heated exterior pipes
- ▶ Special eco-leather upholstery



Zefiro 295 TL



Zefiro 265 TL



Zefiro 295 TL



Zefiro 265 TL, 284 TL, 294 TL, 295 TL



Zefiro 265 TL, 284 TL, 294 TL, 295 TL



Zefiro 295 TL



Zefiro 295 TL



granduca

in your motorcaravan and on the road like at home.

DISCERNING MOTORHOME OWNERS LOVE GOOD-LOOKING, COMFORTABLE, FUNCTIONAL AND SAFE VEHICLES, WITH AN ATTRACTIVE DESIGN.



Discover Granduca

low-profile

265 TL 5 5 265 P



266 TL 5 4 266 P



282 TL 5 5 282 P



284 TL 5 5 284 P



285 TL 5 5 285 P



295 TL 5 5 295 P

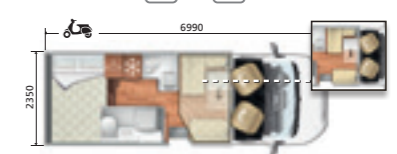

298 TL 5 5

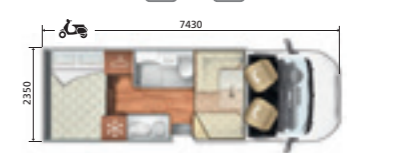

overcab

284 M 4 5



295 M 5 5

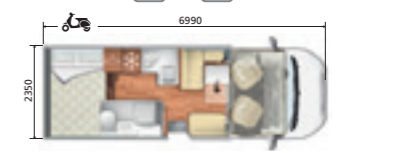

Discerning motorhome owners love good-looking, comfortable, functional and safe vehicles, with an attractive design. Interiors designed to ensure **maximum functionality, ergonomics and space optimisation**: large, rounded overhead lockers, folding table in dinette, kitchen with bins, drawers, tall pull-out units, storage holders on sides, hatches in the floor. Scratch-proof, resilient acrylic stone tops.



Granduca

ALL-INCLUSIVE



- Manual climate control system
- Driver and passenger airbags
- Cruise Control
- Built-in antenna and radio setup
- Central locking two-point door
- Painted bumper
- Pleated blind
- Door with fixed window
- Entrance door flyscreen
- Revolving seats with seat covers
- Bed slats
- Open sky, panoramic roof
- Rear-view camera
- Solar panel
- Parking sensors
- Double battery management system
- Energy saving control unit
- 6-year warranty

Various lengths from 6990 to 7430 mm



9 models to choose from 2 types drop-down and overcab.



Granduca 284 M, 295 M



Granduca 285 TL, 284 TL



Granduca 265 TL



Granduca 265 TL



Granduca 295 M, 295 TL



Granduca 265 TL, 284 M e TL, 295 M e TL



Granduca 265 TL, 284 TL, 285 TL, 295 TL, 298 TL



triacca

the future is now.



Discover Triaca

- ▶ **Open Space:** ergonomic, volumetric interior and furniture design to the benefit of roomy living space.
- ▶ **Innovative materials** with resin and nanotechnology tops: hygienic, antibacterial, mould-proof, waterproof and heat-resistant, easy repairable in case of scuffing and strong.
- ▶ **Equipment:** autonomy and optimised resources.
- ▶ A real double floor to stow longer objects, protected systems, excellent thermal and acoustic insulation, improved structural rigidity.



THIS COMPACT LOW-PROFILE IS CHARACTERISED BY PLENTY OF USABLE AND LIVEABLE SPACE, INNOVATIVE TECHNOLOGICAL STRUCTURE, AUTONOMY AND OPTIMISED RESOURCES.



All elements are transformable – table, bed. The sofa turns into a double bed by means of a quick and easy lifting mechanism.



LIN BUS technology: “home automation” device management with a single connection for controlling all systems. Possibility of managing devices on the Wi-Fi using a mobile phone.



“Energy Saving” control unit: continuous monitoring of available resources and residual autonomy.



“Home” performance. Compressor refrigerator, 165 litres, performance comparable to that of a home fridge and freezer: quick cooling, constant temperature holding even in hot weather, minimum energy consumption and low noise.

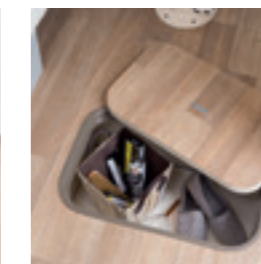

Triaca

ALL-INCLUSIVE



- ▶ Manual climate control system
- ▶ Driver and passenger airbags
- ▶ Cruise Control
- ▶ Built-in antenna and radio setup
- ▶ Central locking two-point door
- ▶ Entrance door flyscreen
- ▶ Painted bumper
- ▶ Pleated blind
- ▶ Revolving seats with seat covers
- ▶ Bed slats
- ▶ Open sky, panoramic roof
- ▶ Rear-view camera
- ▶ Solar panel
- ▶ Parking sensors
- ▶ Double battery management system
- ▶ Energy saving control unit
- ▶ 6-year warranty

low-profile

232 TL 4 4

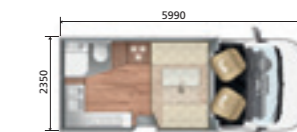

van livingstone

the choice of value and reliability

For more than 10 years, Roller Team has specialised in campervans, which are built in the factory in Paglieta (Abruzzo), an industrial centre of more than 28,000 m² which produces vans for all Europe for the Trigano group.

An established brand on the motorcaravan scene, today Roller Team also specialises in the production of outfitted vans.



+ insulation, + protection,
- noise.
The technology for interior insulation capable of ensuring complete protection for your campervan.



In safe hands with motorcaravan "UnderControl".
Roller Team puts its own experience and expertise at the service of every van produced. A team dedicated to quality control and continuous improvements follows each motorcaravan throughout the production stage with inspections and tests from design to delivery.



Ok, today let's do it like this:
single environment, multiple space
All the space is designed with a view to maximum functionality, modularity and ease of use.



Campervan in the winter? Sure!
Those who say a campervan isn't right for winter holidays never tried a Livingstone. Roller Team campervans dispel this myth and offer everything you need for a problem-free holiday in cold climates.

+ insulation + protection - noise

ExPS Evo, the **exclusive technology** for **insulating the interior** of the **campervan** from **outside temperatures and noises** ensures better heat and acoustic insulation also thanks to the absence of thermal bridges with the outside.

Noise tests

relating to external agents (test carried out with calibrated sound meter and certified by the SIT centre) have also demonstrated that the noise perceived inside the campervan in the event of rain is lower than 37% in the dinette area and -30% in the rear area.

With Extreme Protection System EVO
6-year guarantee
against infiltration!



Discover ExPS EVO



Materials with excellent performance and appropriate construction solutions ensure that the Livingstone campervan has excellent insulation that makes it appropriate for summer and winter use. High performance is guaranteed by the use of material with high insulation performance, polyester fibre covered with a film of aluminium, covering the internal walls, ceiling, crossmembers, pillars and rear doors: **Total coverage.** The flexibility of the material allows it to be inserted in cavities as well. **Absence of thermal bridges.** **Uniform coverage** to promote constant internal temperatures.

Tests in climate chamber in accordance with the EN 1646-1 standard, according to which a vehicle brought to -15° must reach +20° in 4 hours, have demonstrated that ExPS Evo insulation: **Reduces the time** to reach pleasant temperatures inside the vehicle by 50%, even when starting from extremely cold conditions. **Increases the uniformity** of temperature inside the various areas of the campervan by more than 65%. **Maintains temperatures** with greater consistency and longer for more comfortable environments.

campervan in the winter? Sure!

Those who say a **campervan isn't right for winter holidays** never tried a **Livingstone**. **Roller Team campervans dispel this myth and offer everything you need for a problem-free holiday in cold climates.**

Want even more?

Choose between the two additional equipments that enhances on-board comfort still further in the event of the coldest conditions, proving the product best suited to those who prefer certain colder destinations.

Winter Pack:

- ▶ Grey water tank insulated with a 15 mm layer of polyurethane.
- ▶ **Electrical probe with thermostat positioned close to drain valve.**
- ▶ Insulation of external water pipes.
- ▶ Insulation of external heating pipes.

Arctic Pack:

- ▶ **C6 combigas boosted heater**
- ▶ Thermal blind to protect side windows.
- ▶ **Thermal blind to protect dashboard.**
- ▶ Insulated rear curtain.

Exclusive equipment tested in the climate chamber: Livingstone equipped with Arctic Pack reached the target of the standard in 95 minutes!

Same performance as a motorcaravan!

Roller Team has tested its campervans in the climate chamber, basing itself on the EN 1646-1 standard, according to which a vehicle brought to -15° must, once the heating systems have been activated, reach an internal temperature of 20° in 4 hours.

Livingstone, in its basic configuration, fully satisfied the target at a little over 3 and a half hours, thus earning "grade 3" performance.

The result is comparable to the performance of a medium motorhome (with length of 7.4 metres and rear central bed) which, with an internal volume double the campervan but very different build, bodywork and materials, reaches the target in the same time.

This is all possible thanks to ExPS Evo technology, which makes Livingstone a van suited to winter use.

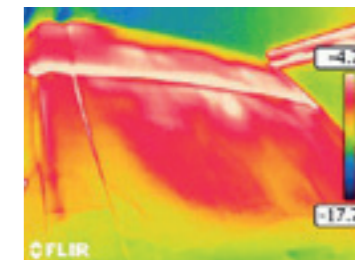

optimized interior space

Home-inspired kitchen

where everything is within arm's reach:

ergonomics and functionality are the keywords

Plenty of room for storage with three deep and stable bins, of which two can be completely extracted with soft-close function. The work top can be extracted easily and forms a level surface without steps. The refrigerators ensure autonomous operation by running on gas, 12 V or 230 W. Shoulder-height refrigerator column by the side of the kitchen to ensure optimal exploitation of the room underneath to make room for a large wardrobe.



USB ports in the day and night zone to recharge smartphones and tablets, right where you need them the most.

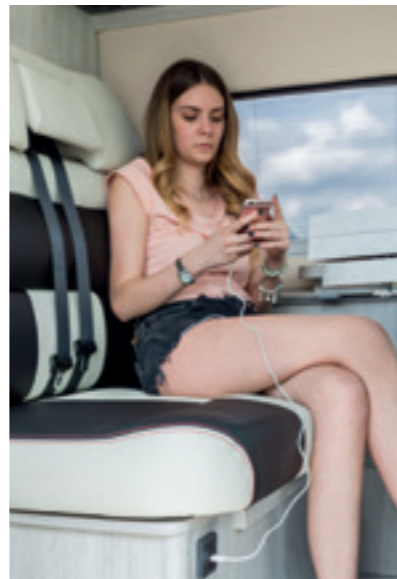

Indirect LED lighting for a uniform and pleasant effect. LED spot lights for reading in the night zone without annoying your travel mates and for more direct light when it is very dark outside. LED technology for better lighting performance and energy saving - energy-efficiency, more autonomy, longer battery life.

Toilette Sliding or tipping wash basin which retracts into the wall. Handy for use only when it is needed. Extractable tap to be used also for the shower. Double drain in the floor: water flows out more easily.



Folding table with extension (Advance pack), which can be dismantled and used outside: comfort and legroom when seated, large surface during use.

Garages equipped for transporting larger items thanks to removable or lift-up beds. Under-bed storage.



Model 6: with central walk-on shower and double sliding blind to separate the areas according to use. Two removable rear lockers for greater storage, only when needed. Open the toilet door in front of the kitchen to create even more room for moving without steps.

Generous wardrobes with adequate interior dimensions to contain garments on hangers and with extra inside height. On some models, wardrobe positioned in lowered position under the refrigerator with large interior size..

Storage compartment under the floor of the dinette.



Extra side bed, where possible, like on Model 6 or Model 2, even the largest in its category.

ok, today let's do it like this!

Single environment, **multiple space.**

The form, furnishings and design choices **guarantee great living volume.**

All the space is designed with a view to maximum functionality, modularity and ease of use.



Livingstone DUO:

6 winning combinations!
The only motorvan that adapts its layout to your loading requirements.

- **1 Lift-up bed bases.**
- **2 Three cupboards that can be removed separately.**
- **3 Removable, adjustable-volume double floor.**
- **4 Extra load, without taking up space**



performance and safety start here

Roller Team motorhomes are built on van specifically designed to be converted taking into account mechanical performance and above all safety, comfort when travelling and when parked over time.

The steering wheel is easy to grasp and a typical automotive slant. It can be adjusted axially with a stroke of 50 mm.

The dashboard features bottle holders and storage compartments, both open and closed, integrated cup holder and container for smartphones or mp3 players.

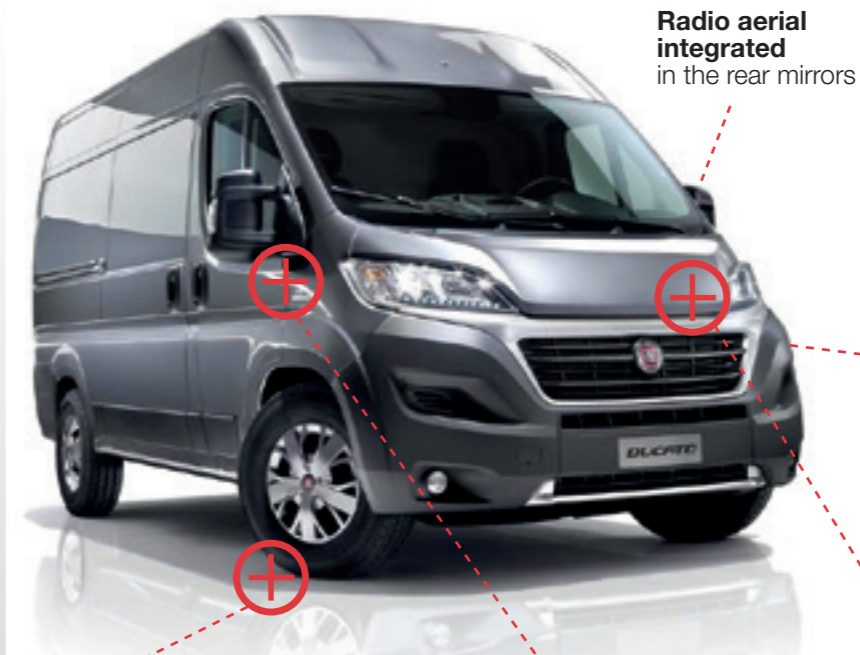

Tyres suitable for long stops and with low rolling resistance to reduce consumption.

Central cab door locking.



Headlights are positioned higher up: with two notable advantages: better light beam width on the road and reduced possibility of damage.

Many variants of Turbo Diesel Euro 6, engines, securing high torque at high rpm for speedy acceleration, fuel efficiency running and low CO₂ emissions.

The **right rims** for your touch of style. Rims are essential to the appearance of the whole vehicle. 15" alloy wheels in two colours available, Dark Grey and Matt Black.

The best cab equipment*:

- Manual climate control system
- Cruise Control with Speed Limiter.
- **ABS** – the wheels do not lock in case of sharp braking and help maintaining directionality.
- **ASR** prevents slipping of the wheels during acceleration.
- **ESC** monitors acceleration, speed and grip.

* Option for base version

LED DRL headlights or fog lights, excellent visibility with peerless lighting, and for longer, optional features.

Chassis Special

- Captain chairs with integrated head restraint, wide backrest, improved side containment, double armrest. On pivoting plate, in addition to being adjustable in height and inclination, they can turn by 180° and once turned they can slide forwards to move closer to the dinette.

The **options** include:

- Traction +: vehicle stability control device, the Hill Holder assistance system for climbs, or Hill Descent system for coming down, and the traction support device for poor grip on a single drive wheel.
- Automatic transmission: increases your driving comfort and reduces fuel consumption by up to 5%.
- TPMS: tyre pressure control system for more safety, better fuel efficiency and lower emissions.

livingstone

designed and made by the specialist that makes only vans

Smart solutions cleverly arranged to exploit

all the possible space



van

K2 4 2



2 4 2+1

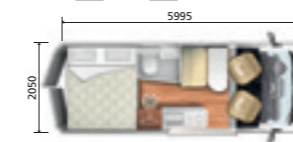

4 4 2+1



5 4 4+1



6 4 2+1



DUO 4 2+1

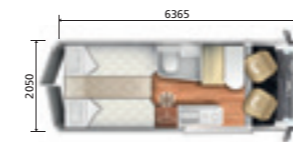

- **Optimised interior space:** hatch in the floor, rear storage spaces, equipped garage lockers, pull-up or removable beds, storage compartments, large overhead lockers.
- **There is a place for everything in the kitchen:** cutlery drawer, two fully extractable bins, extendible work top, double separate cooktop covers, extendible dinette table.
- Toilette with **extremely functional shower:** retractable or sliding washbasins, extractable taps, double drain.
- **The performance of a motorhome:** materials with excellent insulating properties and ideal constructive solutions ensure excellent insulation with "Level 3" performance in climatic chamber.



Discover Livingstone





Livingstone 2



Livingstone 2, 4, 5, DUO



Livingstone 2, 4, 5, 6, DUO



Livingstone 5



Livingstone 2



Livingstone 2, 5



Livingstone 2, 4, 5, DUO



Livingstone 2



Livingstone 2, 5, DUO



Livingstone 2

pack advance

The pinnacle of **excellence**,
with even more equipment
and design!

Equipment:

- ▶ Manual climate control system
- ▶ Passenger airbag
- ▶ Cruise Control
- ▶ Painted bumper
- ▶ Two panoramic skylights
- ▶ Black front grille, headlight bezel and skid plate
- ▶ Electric step
- ▶ Pleated blind
- ▶ Seat covers
- ▶ Wooden shower platform
- ▶ Entrance door flyscreen

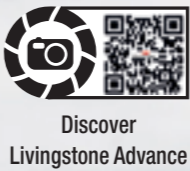

Design and style:

Kitchen with exclusive acrylic stone worktops: resistant to scratches, knocks and rubbing, easy to clean, antibacterial.
Sink with cover which can be used as chopping board or shelf. Acrylic stone backing to prevent liquids from dripping behind.



No sharp edges, rounded profiles in the kitchen, on wardrobes and overhead lockers.



LED lighting, light strips under the overhead lockers to illuminate the worktops and the dinette area, under the worktop to illuminate the open bins.
LED strip in the outer part of the kitchen useful when the dinette table is used outside in the evening.



Protective methacrylate shell on the back of the overhead locker and at the base of the kitchen block: attractive, unique and functional rain protection for when the side door is open.

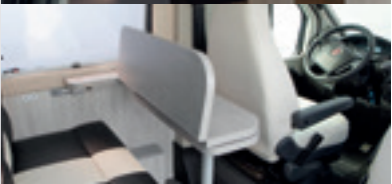

Folding table. comfort and legroom when seated and on the road.



Livingstone 2, 4, 5, DUO Advance



Livingstone 5 Advance



Livingstone 5 Advance



Livingstone 2, 4, 5, 6, DUO Advance



Livingstone DUO Advance



Livingstone DUO Advance



Livingstone DUO Advance



Livingstone 2, 4, 5, 6, DUO Advance



upholsteries

A style that conveys the traits of **Italian design**, the wise choice of materials and **care for each single detail**.

STANDARD ■ - OPTIONAL □

Zefiro



Granduca



Triaca



Livingstone



Kronos



Zefiro Advance



technical data

* Ford
** Fiat
***To increase the vehicle payload, when travelling it is possible to reduce the fresh water tank capacity to approx. 20 lt.

Zefiro	Low profile										
	235 TL	263 TL	265 TL	266 TL	274 TL	282 TL	283 TL	284 TL	285 TL	294 TL	295 TL
Mechanical unit, engine, power hp	Fiat Ducato 2,3 MJ 96 KW (130 HP)										
Maximum technically permissible weight (Kg)	3500	3500	3500	3500	3500	3500	3500	3500	3500	3500	3500
Homologated seats / Berths	4 / 4	5 / 4	5 / 4	5 / 4	7 / 7	5 / 4	5 / 4	5 / 4	5 / 4	5 / 4	5 / 4
External lenght / width (mm)	6990 / 2350	6990 / 2350	7450 / 2350	7450 / 2350	7300 / 2350	7430 / 2350	6990 / 2350	7450 / 2350	6990 / 2350	6410 / 2350	6990 / 2350
External / Internal height (mm)	2950 / 2080	2950 / 2080	2950 / 2080	2950 / 2080	2950 / 2080	2950 / 2080	2950 / 2080	2950 / 2080	2950 / 2080	2950 / 2080	2950 / 2080
Fridge (L) - Trivalent fridge	140 L	140 L	140 L	140 L	140 L	140 L	140 L	140 L	140 L	140 L	150 L
Heating - Combined Gas	4000 W	4000 W	4000 W	4000 W	4000 W	4000 W	4000 W	4000 W	4000 W	4000 W	4000 W
Rear Bed (mm)	-	1900x1360	1900x1360	1900x1360	2 x 2160x920(760)	2015x755 / 1910x755	2030x780/1940x780	2080x780/1980x780	2050x780/1840x780	2070x1270(1090)	2030x1310
Bed in Dinette (mm)	2160x1550(1250)	2160x960(510)	2160x1110(560)	2160x1100(560)	2020x1250/1900x600	2160x1070(530)	2160x960(510)	2160x1110(560)	2160x1240(560)	2160x1110(560)	2160x1110(560)
Overcab bed (mm)	-	-	-	-	-	-	-	-	-	-	-
Elevating Bed (mm)	1900x1320(1240)	1900x1160(950)	1900x1280(1070)	1900x1280(1070)	1900x1320(1240)	1900x1280(1070)	1900x1160(950)	1900x1280(1070)	1900x1240(1030)	1900x1280(1070)	1900x1280(1070)
Tank capacity: clear water / wastewater (L***)	20(100) / 100	20(100) / 100	20(100) / 100	20(100) / 100	20(100) / 100	20(100) / 100	20(100) / 100	20(100) / 100	20(100) / 100	20(100) / 100	20(100) / 100

Zefiro advance	Low profile			
	265 TL	284 TL	294 TL	295 TL
Mechanical unit, engine, power hp	Fiat Ducato 2,3 MJ 96 KW (130 HP)			
Maximum technically permissible weight (Kg)	3500	3500	3500	3500
Homologated seats / Berths	5 / 4	5 / 4	5 / 4	5 / 4
External lenght / width (mm)	7450 / 2350	7450 / 2350	6410 / 2350	6990 / 2350
External / Internal height (mm)	2950 / 2080	2950 / 2080	2950 / 2080	2950 / 2080
Fridge (L) - Trivalent fridge	140 L	140 L	140 L	150 L
Heating - Combined Gas	4000 W	4000 W	4000 W	4000 W
Rear Bed (mm)	1900x1360	2080x780/1980x780	2070x1270(1090)	2030x1310
Bed in Dinette (mm)	2160x1110(560)	2160x1110(560)	2160x1240(560)	2160x1110(560)
Overcab bed (mm)	-	-	-	-
Elevating Bed (mm)	1900x1280(1070)	1900x1280(1070)	1900x1280(1070)	1900x1280(1070)
Tank capacity: clear water / wastewater (L***)	20(100) / 100	20(100) / 100	20(100) / 100	20(100) / 100

Granduca	Low profile			
	265 TL	266 TL	282 TL	284 TL
Mechanical unit, engine, power hp	Fiat Ducato 2,3 MJ 96 KW (130 HP)			
Maximum technically permissible weight (Kg)	3500	3500	3500	3500
Homologated seats / Berths	5 / 5	5 / 5	5 / 5	5 / 5
External lenght / width (mm)	7430 / 2350	7450 / 2350	7430 / 2350	7430 / 2350
External / Internal height (mm)	2950 / 2080	2950 / 2080	2950 / 2080	2950 / 2080
Fridge (L) - Trivalent fridge	140 L	140 L	140 L	140 L
Heating - Combined Gas	4000 W	4000 W	4000 W	4000 W
Rear Bed (mm)	1900x1360	1990x730/1890x730	2010x760/1960x760	2010x760/1960x760
Bed in Dinette (mm)	2120x850(590)	2120x850(590)	2120x850(590)	2120x850(590)
Overcab bed (mm)	-	-	-	-
Elevating Bed (mm)	1900x1320(1110)	1900x1320(1110)	1900x1320(1110)	1900x1320(1110)
Tank capacity: clear water / wastewater (L***)	20(100) / 100	20(100) / 100	20(100) / 100	20(100) / 100

Kronos	Low profile							Overcab				Motorhome			
	294 TL	295 TL	277 M	279 M	284 M	290 M	295 M	265 INTEGRAL	267 INTEGRAL	284 INTEGRAL	287 INTEGRAL	265 INTEGRAL	267 INTEGRAL	284 INTEGRAL	287 INTEGRAL
Mechanical unit, engine, power hp	Ford Transit 2,0 TDI 96KW (130 HP) / Fiat Ducato 2,3 MJ 96 KW (130 HP)							Ford Transit 2,0 TDI 96KW (130 HP) / Fiat Ducato 2,3 MJ 96 KW (130 HP)				Fiat Ducato 2,3 MJ 96 KW (130 HP)			
Maximum technically permissible weight (Kg)	3500	3500	3500	3500	3500	3500	3500	3500	3500	3500	3500	3500	3500	3500	3500
Homologated seats / Berths	5 / 4	5 / 4	7 / 7	6 / 8	5 / 4	5 / 4	6 / 6	5 / 4	4 / 4	5 / 4	4 / 4	5 / 4	4 / 4	5 / 4	4 / 4
External lenght / width (mm)	6410 / 2350	6990 / 2350	6990 / 2350	6990 / 2350	7450 / 2350	7450 / 2350	7120 / 2350	7450 / 2350	7450 / 2350	7450 / 2350	7450 / 2350	7450 / 2350	7450 / 2350	7450 / 2350	7450 / 2350
External / Internal height (mm)	2950 / 2080	2950 / 2080	3200 / 2080	3200 / 2080	3200 / 2080	3200 / 2080	3200 / 2080	2900 / 2080	2900 / 2080	2900 / 2080	2900 / 2080	2900 / 2080	2900 / 2080	2900 / 2080	2900 / 2080
Fridge (L) - Trivalent fridge	140 L	140 L	140 L	140 L	140 L	140 L	140 L	140 L	140 L	140 L	140 L	140 L	140 L	140 L	150 L
Heating - Combined Gas	4000 W	4000 W	4000 W	4000 W	4000 W	4000 W	4000 W	4000 W	4000 W	4000 W	4000 W	4000 W	4000 W	4000 W	4000 W
Rear Bed (mm)	2160x1350(1180)	2150x1350(1200)	2150x775/2120x800	2160x1300(1120)/2100x1100	2080x800/1980x800	2120x1890	2160x1300(1120)	1900x1500	1900x1500	2080x800/1980x800	1980x800/1930x800	1900x1500	1900x1500	2080x800/1980x800	1980x800/1930x800
Bed in Dinette (mm)	2120x1130(500)	2120x1330(500)	1860x1250/1620x600	1860x1250	2120x1130(500)	2120x1130(500)	1860x1250	2120x1130(500)	-	2120x1130(500)	-	2120x1130(500)	-	2120x1130(500)	-
Overcab bed (mm)	-	-	2090x1600	2090x1600	2090x1130	2090x1600	2090x1600	-	-	-	-	-	-	-	-
Elevating Bed (mm)	1900x1160(550)	1900x1200(1070)	-	-	-	-	-	1890x1350	1890x1350	1890x1350	1890x1350	1890x1350	1890x1350	1890x1350	1890x1350
Tank capacity: clear water / wastewater (L***)	20(100) / 120 *-100 **	20(100) / 120 *-100 **	20(100) / 120 *-100 **	20(100) / 120 *-100 **	20(100) / 120 *-100 **	20(100) / 120 *-100 **	20(100) / 120 *-100 **	20(100) / 100	20(100) / 100	20(100) / 100	20(100) / 100	20(100) / 100	20(100) / 100	20(100) / 100	20(100) / 100

Zefiro	Low profile					Overcab		Motorhome						
	298 TL	277 M	284 M	285 M	295 M	265 INTEGRAL	266 INTEGRAL	282 INTEGRAL	284 INTEGRAL	285 INTEGRAL	295 INTEGRAL	265 INTEGRAL	266 INTEGRAL	282 INTEGRAL
Mechanical unit, engine, power hp	Fiat Ducato 2,3 MJ 96 KW (130 HP)													
Maximum technically permissible weight (Kg)	3500	3500	3500	3500	3500	3500	3500	3500	3500	3500	3500	3500	3500	3500
Homologated seats / Berths	5 / 4	7 / 7	5 / 4	5 / 4	6 / 6	5 / 4	5 / 4	5 / 4	5 / 4	5 / 4	5 / 4	5 / 4	5 / 4	5 / 4
External lenght / width (mm)	7430 / 2350	6990 / 2350	7450 / 2350	6990 / 2350	6990 / 2350	7450 / 2350	7450 / 2350	7390 / 2350	7450 / 2350	6970 / 2350	6970 / 2350	7450 / 2350	6970 / 2350	6970 / 2350
External / Internal height (mm)	2950 / 2080	3200 / 2080	3200 / 2080	3200 / 2080	3200 / 2080	2950 / 2080	2950 / 2080	2950 / 2080	2950 / 2080	2950 / 2080	2950 / 2080	2950 / 2080	2950 / 2080	2950 / 2080
Fridge (L) - Trivalent fridge	150 L	150 L	140 L	140 L	150 L	140 L	140 L	140 L	140 L	140 L	140 L	140 L	140 L	150 L
Heating - Combined Gas	Combined Gas 4000 W													
Rear Bed (mm)	2070x1270	2200x775/2150x775	2080x780/1980x780	2050x780/1840x780	2070x1260(1080)	1900x1360	1900x1360	2015x755/1910x755	2080x780/1980x780	1955x780/1820x780	2030x1310	2015x755/1910x755	1900x1360	1900x1360
Bed in Dinette (mm)	2120x1500(850)	1850x1250/1690x670	2160x1100(560)	2160x1260(510)	1850x1250	2160x1110(560)	2160x1110(560)	2160x1070(530)	2160x1110(560)	2160x1250(625)	2120x680(540)	2160x1110(560)	2160x1110(560)	2160x1110(560)
Overcab bed (mm)	-	2020x1600	2020x1600	2000x1600	2020x1600	-	-	-	-	-	-	-	-	-
Elevating Bed (mm)	1900x1320(1240)	-	-	-	-	1890x1350	1890x1360	1890x1360	1890x1350	1890x1350	1890x1350	1890x1350	1890x1360	1890x1360
Tank capacity: clear water / wastewater (L***)	20(100) / 100	20(100) / 100	20(100) / 100	20(100) / 100	20(100) / 100	20(100) / 100	20(100) / 100	20(100) / 100	20(100) / 100	20(100) / 100	20(100) / 100	20(100) / 100	20(100) / 100	20(100) / 100

Granduca	Low profile					Overcab	
	285 TL	295 TL	298 TL	284 M	295 M	285 TL	295 M
Mechanical unit, engine, power hp	Fiat Ducato 2,3 MJ 96 KW (130 HP)						
Maximum technically permissible weight (Kg)	3500	3500	3500	3500	3500	3500	3500
Homologated seats / Berths	5 / 5	5 / 5	5 / 5	4 / 5	5 / 5	5 / 5	5 / 5
External lenght / width (mm)	6990 / 2350	6990 / 2350	7430 / 2350	7410 / 2350	6990 / 2350	6990 / 2350	6990 / 2350
External / Internal height (mm)	2800 / 2080	2800 / 2080	2800 / 2080	3200 / 2080	3200 / 2080	3200 / 2080	3200 / 2080
Fridge (L) - Trivalent fridge	140 L	140 L	150 L	140 L	150 L	140 L	150 L
Heating - Combined Gas	4000 W	4000 W	4000 W	4000 W	4000 W	4000 W	4000 W
Rear Bed (mm)	2010x760/1900x760	2030x1310	2030x1270(1190)	2010x760/1960x760	2030x1310	2030x1310	2030x1310
Bed in Dinette (mm)	2120x850(590)	2120x850(590)	2120x850(500)	2120x850(590)	2120x850(590)	2120x850(590)	2120x850(590)
Overcab bed (mm)	-	-	-	2020x1600	2020x1600	2020x1600	2020x1600
Elevating Bed (mm)	1900x1320(1110)	1900x1320(1110)	1900x1320(1270)	-	-	-	-
Tank capacity: clear water / wastewater (L***)	20(100) / 100	20(100) / 100	20(100) / 100	20(100) / 100	20(100) / 100	20(100) / 100	20(100) / 100

Certified vehicle weight comprises: driver (75 Kg), fuel tank 100% fully filled (Fiat 60 L), fresh water tank filled to 20 lt. (use of special drain valve) and aluminium gas bottles (max. 15 kg.) filled at 100% of their capacity, and certified tolerance (Directive 2007/46/CE). Anything which is not included in the standard version of the vehicle, concerning both living quarters and chassis, entails an increase of the mass in running order, with the consequent reduction in the useful load up to the possible reduction in the number of certified seats in case the total weight exceeds the value of the available payload. The available payload consists in the difference between the maximum permissible weight and the mass in running order, with a tolerance of 5%. Therefore, during the purchase phase it is recommended to carefully consider the weight of any optional equipment you wish to install on the vehicle. This weight is indicated in the specific item of the technical data on www.rollerteam.it. Hence, please remember that the laws in force do not allow the maximum permissible weight indicated in the specific item of the technical data sheets to be exceeded.

technical data



Triaca	Low profile
Mechanical unit, engine, power hp	Fiat Ducato 2,3 MJ 96 KW (130 HP)
Maximum technically permissible weight (Kg)	3500
Homologated seats / Berths	4 / 4
External lenght / width (mm)	5990 / 2350
External / Internal height (mm)	2990 / 2080
Fridge (L) - Compressor fridge	165 L
Heating - Combined Fuel Oil	6000 W
Rear Bed (mm)	-
Bed in Dinette (mm)	2120x1460(1220)
Overcab bed (mm)	-
Elevating Bed (mm)	1900x1370(1270)
Tank capacity: clear water / wastewater (L***)	20(100) / 100

***To increase the vehicle payload, when travelling it is possible to reduce the fresh water tank capacity to approx. 20 lt.

Certified vehicle weight comprises: driver (75 Kg), fuel tank 100% fully filled (Fiat 60 L), fresh water tank filled to 20 lt. (use of special drain valve) and aluminium gas bottles (max. 15 kg.) filled at 100% of their capacity, and certified tolerance (Directive 2007/46/CE). Anything which is not included in the standard version of the vehicle, concerning both living quarters and chassis, entails an increase of the mass in running order, with the consequent reduction in the useful load up to the possible reduction in the number of certified seats in case the total weight exceeds the value of the available payload. The available payload consists in the difference between the maximum permissible weight and the mass in running order, with a tolerance of 5%. Therefore, during the purchase phase it is recommended to carefully consider the weight of any optional equipment you wish to install on the vehicle. This weight is indicated in the specific item of the technical data on www.rollerteam.it. Hence, please remember that the laws in force do not allow the maximum permissible weight indicated in the specific item of the technical data sheets to be exceeded.



Trigano S.p.A. operates with an Integrated Quality, Environment and Safety Management System.
Certificate number: ISO14001: 2939;
OHSAS18001: 1258; ISO9001: 11841

Livingstone	Van	LIVINGSTONE K2	LIVINGSTONE 2	LIVINGSTONE 4	LIVINGSTONE 5	LIVINGSTONE 6	LIVINGSTONE DUO
Mechanical unit, engine, power hp	Fiat Ducato 2,0 MJ 85 KW (115 HP) - 33	Fiat Ducato 2,0 MJ 85 KW (115 HP) - 33				Fiat Ducato 2,3 MJ 96 KW (130 HP) - 35	
Maximum technically permissible weight (Kg)	3300	3300	3300	3300	3300	3500	
Homologated seats / Berths	4 / 2	4 / 2+1	4 / 2+1	4 / 4+1	4 / 2+1	4 / 2+1	
External lenght (mm) / External width (mm)	5410 / 2050	5995 / 2050	5995 / 2050	5995 / 2050	5995 / 2050	6365 / 2050	
External height (mm) / Internal height (mm)	2650 / 1890	2650 / 1890	2650 / 1890	2650 / 1890	2650 / 1890	2650 / 1890	
Fridge (L)	compressor fridge 85 L	trivalent fridge 80 L	trivalent fridge 140 L	trivalent fridge 80 L	compressor fridge 85 L	trivalent fridge 80 L	
Heating - Combined Fuel Oil	4000 W	4000 W	4000 W	4000 W	4000 W	4000 W	
Rear Bed (mm)	1900x1330	1900x1440	1900x1440	1860x1400/1860x1320	1740x750/1900x780	1950x800/1900x800	
Bed in Dinette (mm)	-	1800x970	1800x970	1800x970	1750x900	1750x900	
Tank capacity: clear water / wastewater (L***)	20 (90) / 90	20 (100) / 90	20 (100) / 90	20 (100) / 90	20 (90) / 90	20 (100) / 90	





NOTICE - All the information and photos shown herein are to be considered as merely indicative and do not constitute contractual specifications. Trigano S.p.A. reserves the right to make the technical and configuration changes considered appropriate to its vehicles and to change the equipment the vehicles are provided with at any time and with no official notice. Owing to the above, all the information concerning the specifications and equipment of every motorcaravan must be requested before purchase from the dealer, who, acting as sole point of reference, will confirm or rectify the data published herein, updating the customer on the actual features and equipment of the vehicle he/she is interested in and for which negotiations are ongoing. Trigano S.p.A. declines any liability concerning changes, including additions, and/or conversions made after the printing of this document and/or delivery of the vehicle. Weights and dimensions of vehicles and options are subject to change with a tolerance of +/- 5%, dimensions of vehicles with a tolerance of +/- 3%, according to the Directive 2007/46/CE. Important note: Anything which is not included in the standard version of the vehicle, concerning both living quarters and chassis, entails an increase of the mass in running order, with the consequent reduction in the useful load up to the possible reduction in the number of certified seats in case the total weight exceeds the value of the available payload. The available payload consists in the difference between the maximum permissible weight and the mass in running order, with a tolerance of 5%. Therefore, during the purchase phase it is mandatory to carefully consider the weight of any optional equipment you wish to install on the vehicle. This weight is indicated in the specific item of the technical data on www.rollerteam.it. Hence, please remember that the laws in force do not allow the maximum permissible weight indicated in the specific item of the technical data sheets to be exceeded.

It is recommended that each user adjust the load and the number of passengers carried to the maximum technically permissible maximum mass of the vehicle. Fitting, removing or alterations carried out c/o unauthorised workshops may compromise your safety and at the same time lead to invalidation of the warranty.

The world Roller Team in a click. All the news in real time, special events, limited offers and much more. Go online now on your PC, tablet or smartphone and enjoy an on-line word of Roller Team: www.rollerteam.it

Photos: Simone Burchi - Render: Extrò - Ed. 01 - EN - 8/2018 **GERECON**

ROLLER TEAM

TRIGANO SpA Loc.Cusona, 53037 - San Gimignano (Siena) Italy - Tel. +39 0577 6501 - info@rollerteam.it - www.rollerteam.it



DEALER'S STAMP

